

GPN 362

NEW

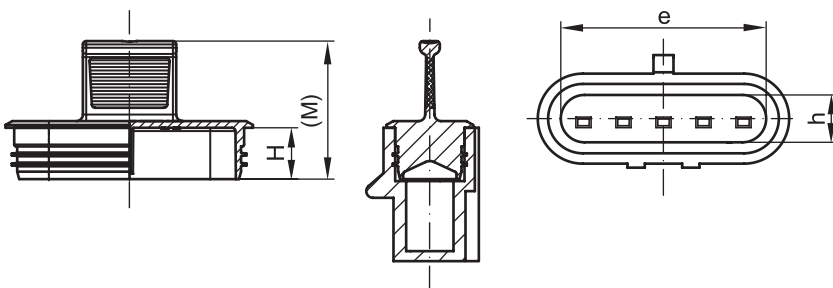

Standard colour: yellow
Material: PE-LD



Fits better.

Protection for Superseal flat connector housings.



Saves time.

With practical tab for fast removal.



Seals better.

Protection against splashing water from any direction (IPX4) depending on the specific connector design and quality.**



Cleaner.

Upon request, we can manufacture in the specially designed cleanroom in accordance with VDA Volume 19 and ISO 16232. For further information, please refer to page 129.



Better.

Optimum clamping fit thanks to circumferential fins.

item	Suitable for internal contour		Dimensions		Order no.
	e	h	H	(M)	
GPN 362 KS 0111	10,7	10,7	7,7	20,7	362 0111 0000
GPN 362 KS 0211	16,8	10,7	7,7	20,7	362 0211 0000
GPN 362 KS 0311	22,8	10,7	7,7	20,7	362 0311 0000
GPN 362 KS 0511	34,9	10,7	7,7	20,7	362 0511 0000
GPN 362 KS 0611*	40,7	10,4	6,7	19,7	362 0611 0000

Size in mm

For information regarding materials, colours, drawings and the use of our items, please refer to pages 124/125.

* This size is not IPX4 certified.

Application Guide

Suitable for contact connectors

Superseal 1.5 Pole number					Rows		item
1	2	3	5	6	1	2	
.					.		GPN 362 KS 0111
	.				.		GPN 362 KS 0211
		.			.		GPN 362 KS 0311
			.		.		GPN 362 KS 0511
				.	.		GPN 362 KS 0611*

The contact protection GPN 362 was developed for the Superseal flat connection housings listed in the application table. The contact protection is also suitable for other connections.

* This size is not IPX4 certified.

** Related to Pöppelmann sample connector, tested according to DIN 40050. Please refer to the note on page 125.

You might also be interested in the following products: GPN 360, GPN 361, GPN 363, GPN 364, GPN 365